

**Marine  
Department**

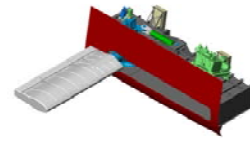

**Engineering for Marine Equipment**

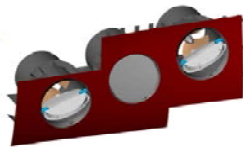
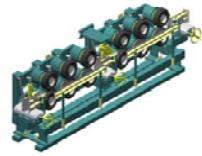

**Service above everything else**

## MAINTENANCE



### HISTORICAL RECORD OF THE FL MARINE DEPARTMENT

The FL Marine Department and its predecessors (ACH & ACH Engineering) have supplied over one hundred special naval systems, such as stabilizers, cable-laying equipment, steering gear, etc. Most of these systems are still in service all around the world. That's why we propose a service of spare parts and the experience of our specialized technicians.

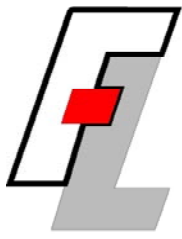

**Marine  
Department**

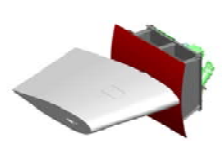
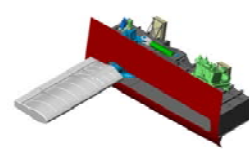
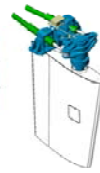
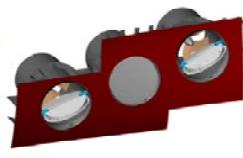
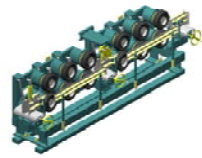

## **Engineering for Marine Equipment**

**SOME SHIPS ON WHICH FL MARINE DEPARTMENT TEAMS HAVE RECENTLY OPERATED**



### **A WORLDWIDE OPERATING TEAM**

- **After sales service**
- **Emergency repairs**
- **Preventive maintenance**
- **Supply of specific tools**
- **Logistics service**
- **Management of spare parts**

Throughout the lifespan of the installations, the FL Marine Department can ensure emergency repairs and preventive maintenance, particularly for the anti-roll stabilizers supplied by ACH Engineering.

At the ship operator's request, specialists can be delegated at short notice on board ships, wherever the ships are located. They can be provided with specialized tooling and spare parts, if necessary.

A logistics team is specially assigned to the management of spare parts.

### **Multi-disciplinary team moving all around the world in harbour or at sea**

Dismounting and changing mechanical parts, checking hydraulic components, changing submerged parts with the assistance of divers, checking operating modes of control-command devices, updating data processing, offering technical support during dry dock operations, etc.

### **Maintenance and repairs on special purpose equipment**

Anti-roll stabilizers (with fin and active tanks), cable-laying equipment, steering gears, tunnel covers for bow thrusters, tender platforms, etc. and other equipment upon request.

### **On all types of ships for both merchant marine and naval vessels**

Cruise liners (classic and sail assisted), ferry boats, container ships, cable layers, frigates (La Fayette class - Delta and Sawari II programs), aircraft carriers (Charles de Gaulle), minehunters, etc.

### **Many famous companies have called on FOURE LAGADEC Marine Department for assistance**

Royal Caribbean Cruise Lines, Norwegian Cruise Lines, Cie Iles du Ponant, Cie Morbihanaise de Navigation, Cruise Invest, Cunard Line Ltd, Windstar Cruises, Princess Cruises, My Ferry Link, Société Nationale Corse Méditerranée, V-Ships and the navies of France, Australia, Singapore, Saudi Arabia, Spain and Norway among others.